

Mooer

Assembly instructions for TF Series Pedal Boards TF 系列效果器板安装说明

TF Pedal Board Components

产品外观概览

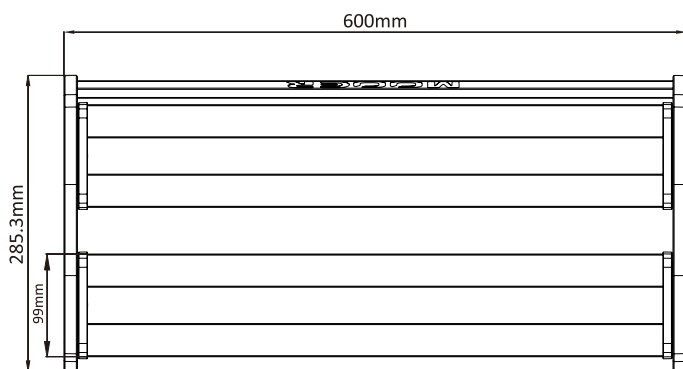
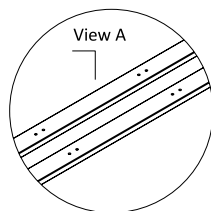
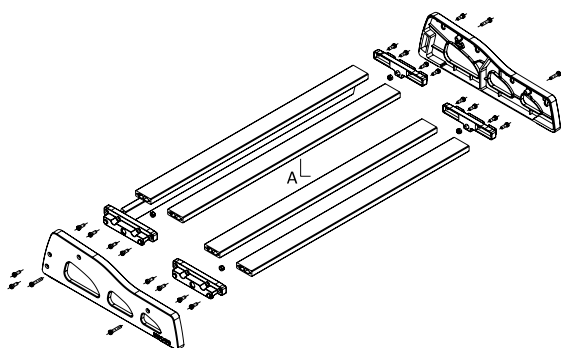

TF-20

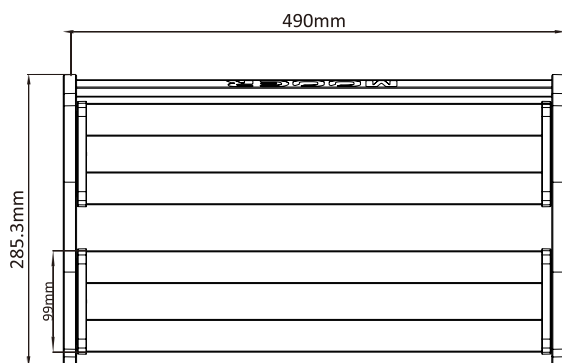

TF-16



Example of the TransFormable pedal platforms 变形示意

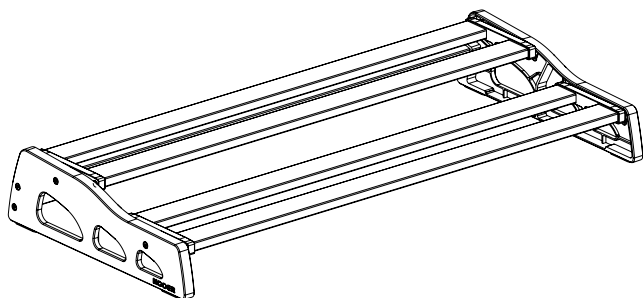

1

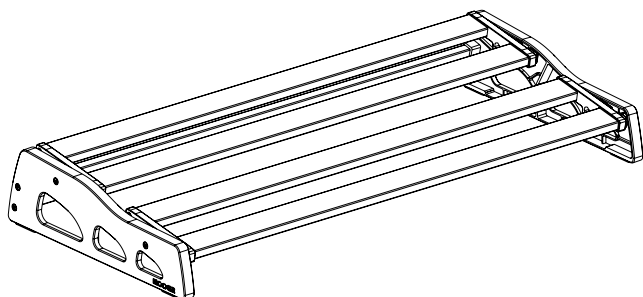

2

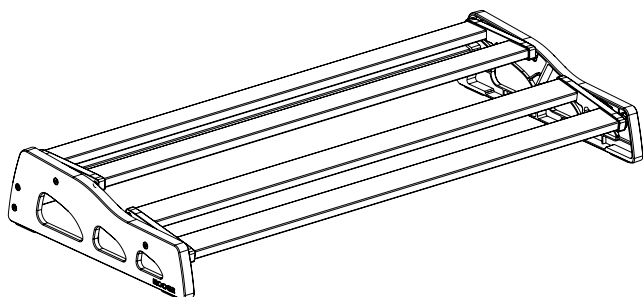

3

Box Contents

组装步骤

Please check that the contents of your box are correct. (Picture 1)
依照如下清单（图1）核对配件是否完整

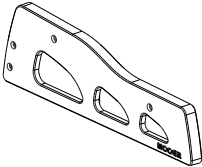

1 PCS
314000026

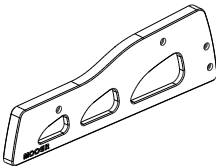

1 PCS
314000027

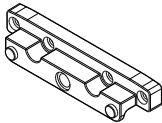

4 PCS
314000031



314000028 (TF-20 562*32*10mm)
314000032 (TF-16 452*32*10mm)

2 PCS

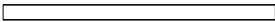

314000029 (TF-20 562*32*10mm)
314000033 (TF-16 452*32*10mm)

2 PCS



314000030 (TF-20 590*32*10mm)
314000034 (TF-16 480*32*10mm)

1 PCS

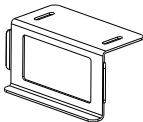

2 PCS
399000026

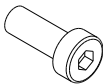

20 PCS
301020019
10mm

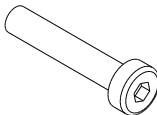

4 PCS
301020018
20mm



4 PCS
307010005



4 PCS
301020020



4 PCS
616020026



1 PCS
309000003



4 PCS
699000049 (TF-20 554*30mm)
699000055 (TF-16 444*30mm)

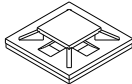

10 PCS
699000052

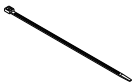

15 PCS
699000051

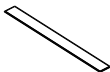

1 PCS
699000013

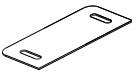

2 PCS
617010015

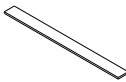

2 PCS
617010014 (80*7*1mm)



4 PCS
617010013 (40*7*1mm)

(Picture 1)

STEP 1:Adjustable pedal platforms 踏板活动单元组成

1、Use the following components. (picture 2)

找出下图的组件及数量 (图2)

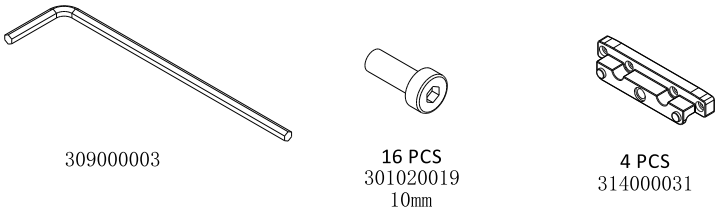

(Picture 2)

2、Divide the platform bracket beams into two groups. Pair up the two pieces which have threaded holes on their face into one group. This will be for platform-1 in the next step. Pair up the two pieces without the threaded holes into a second group. (Picture 3)
如下组件分为两组，底面打有螺丝孔的两为一组，其余两根为另一组。(图3)

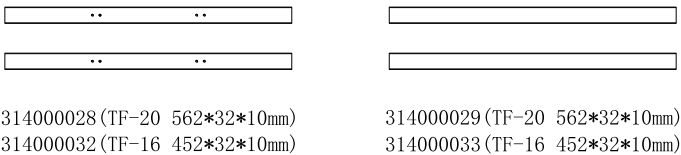

(Picture 3)

3、Layout the two groups of parts from the previous step on a flat surface. Be sure that the pair with the extra threaded holes are both laid out together with the holes facing down. Attach the end sections of the platforms (314000031) using the supplied bolts. (Picture 4)

将4块 314000031用螺丝安装在两组组件两端 (314000028 (TF-20) /314000032(TF-16) 打有螺丝孔的平面朝下)，完成Platform-1和Platform-2的安装。(图4)

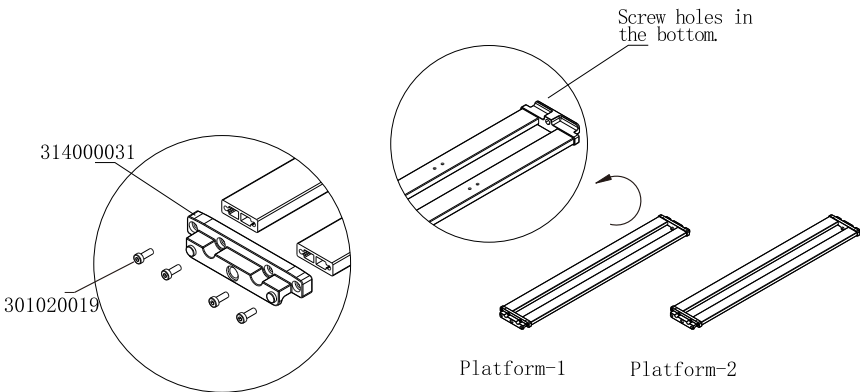

(Picture 4)

STEP2:Main Assembly 支架结构安装

1、Use the following components. (picture 5)

找出下图的组件及数量 (图5)

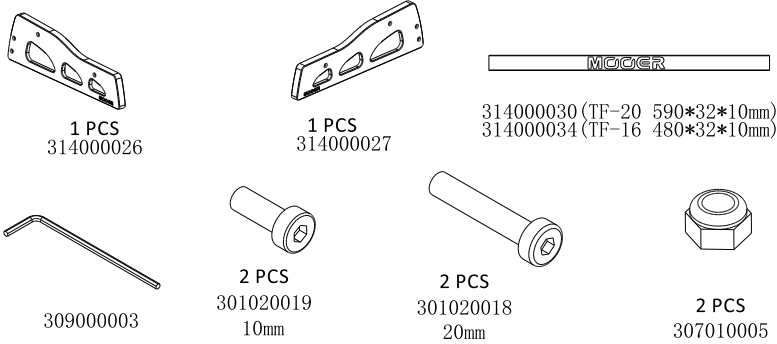

(Picture 5)

1、Do not tighten the bolts all the way until all bolts are in place. After all bolts are in place and 90% threaded into the hole, you can pinch them tight. (Picture 6)

*以下步骤勿在第一时间上紧螺丝，过紧的安装，会增加另一端的安装难度

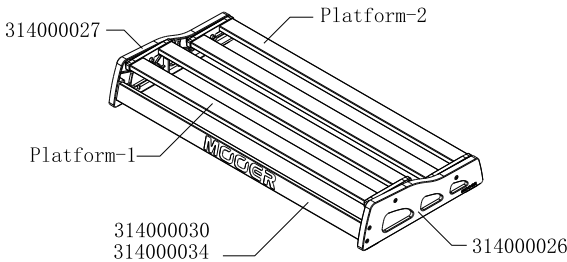

(Picture 6)

2、Install the MOOER branded rear bracket 314000030(TF-20)/314000034(TF-16) into the slot of the left side panel (314000026) and secure in place 90% using two 301020019 bolts. Then insert two nuts (307010005) into the retaining slots of Platform-1 and Platform-2. Now attach both platforms to the side panel using bolts (301020018). Only tighten the bolts 90%. Please note that Platform-1 should be nearest to the rear bracket. (Picture 7)

将Platform-1、Platform-2及314000030(TF-20)/314000034(TF-16)分别嵌入左侧支架 (314000026) 的卡槽内，并旋上对应的螺丝至无明显晃动 (Platform-1位于较高的水平位置)，在扭紧螺丝前，将Platform-1 和 Platform-2 调整到需要的角度 (参考第一页的变形示意)。(图7)

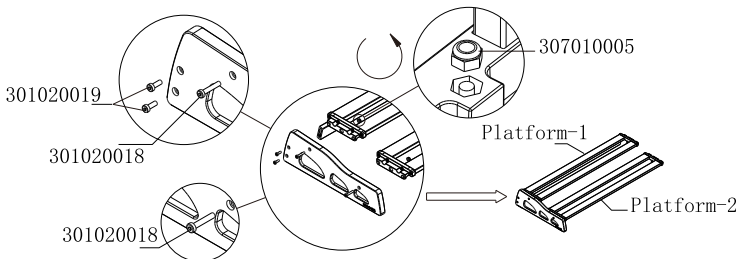

(Picture 7)

3、 Follow the same directions from the previous step to assemble the right side panel. After everything's in place you can tighten the rear bracket retaining bolts, then rotate the two pedal platforms into your desired position before tightening their retaining bolts. (Picture 8)

用相同的方法连接右侧侧支架（314000027）与本体组件的安装，并上紧所有螺母。在扭紧螺丝前，将Platform-1 和 Platform-2 调整到需要的角度（参考第一页的变形示意）。（图8）

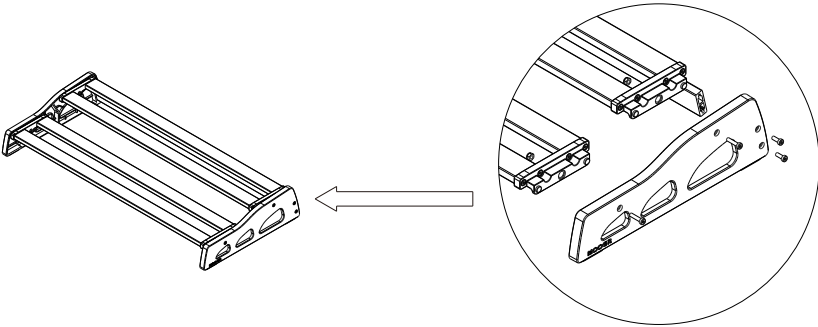

(Picture 8)

STEP3: Foot Pads 脚垫安装

1、 Install the self-adhesive rubber foot pads (616020026) into the provided slots on the base of the two side panels. (Picture 9)

在两块支架底部安装四个橡胶脚垫(616020026)，由此完成本体结构安装。（图9）

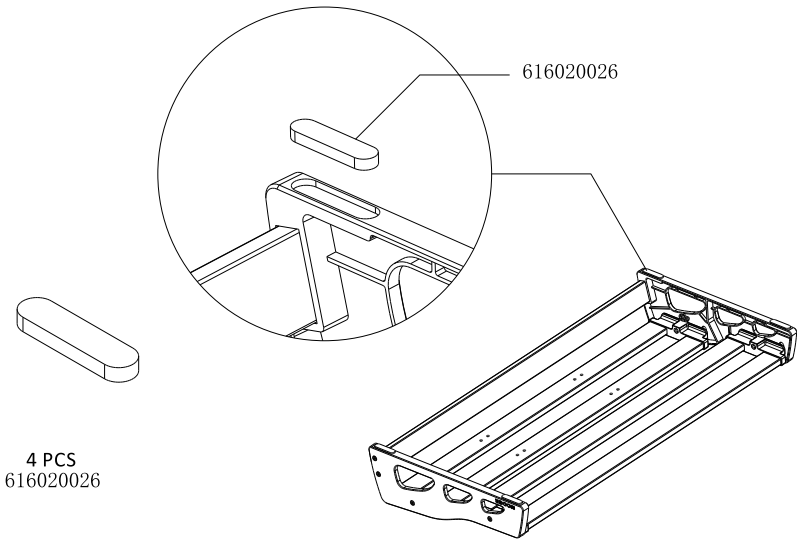

(Picture 9)

STEP4:Power Supply Brackets 电源安装

1、 Please ensure that there is no moisture or dust on the surface of the power supply brackets.

确认电源支架表面没有影响粘性的污渍、粉尘等

2、 Apply the self-adhesive, EVA, non-slip pads in the correct position on the power supply Brackets. (Picture 10)

将EVA泡棉及防滑垫贴在电源支架相应的位置。(图10)

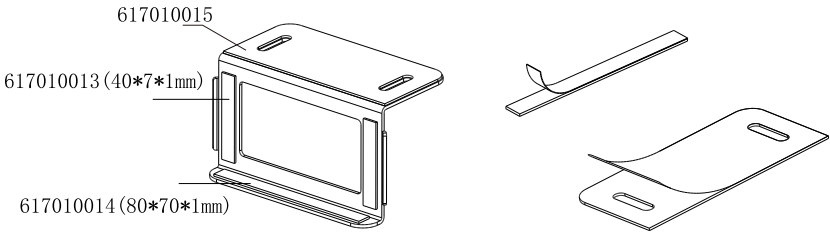

(Picture 10)

3、 Use the following components. (picture 11)

找出下图的组件及数量 (图11)

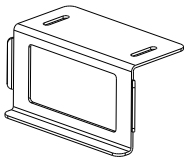

2 PCS
399000026

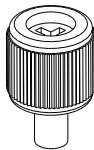

4 PCS
301020020

(Picture 11)

4、 Position the TF-20/TF-16 face down on a flat surface. Position your power supply followed by both power supply brackets ensuring there is no restriction to cable jacks and power cord sockets. Lock the power supply brackets in place using the plastic surrounded hand bolts. There's no need to use a screw driver. Just pinch the brackets tight using your hands. This will allow the brackets to remain adjustable without the need of any tools and avoid damage to the power supply (Picture 12)

将TF-20底面朝上，用手拧螺钉连接电源支架与矩形梁，使支架保持可左右调整的状态。(图12)

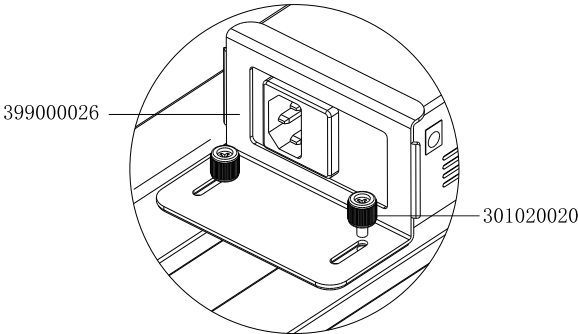

(Picture 12)

将电源放置在矩形梁底部，并嵌在支架内，安装另一端电源支架，调整两边支架的距离，确保电源与支架良好贴合，拧紧手拧螺钉。（图13）

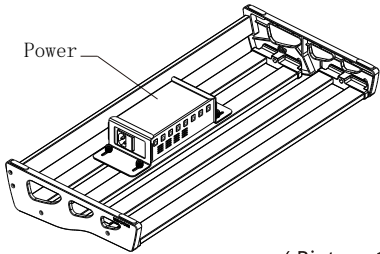

Mooer Macro Power S8 is recommended.
(推荐使用Mooer Macro Power S8)

(Picture 13)

STEP5: Velcro 安装魔术贴

1、Use the following components. (Picture 14)
找出下图的组件和数量（图14）

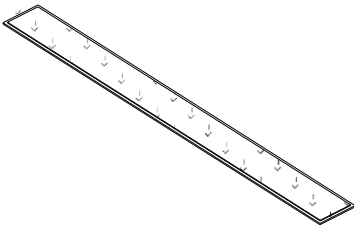

4 PCS
699000049 (TF-20 554*30mm)
699000055 (TF-16 444*30mm)

(Picture 14)

2、Please ensure that there is no moisture or dust on the surface of the pedal platforms.
确认矩形梁正面没有影响粘性的污渍、粉尘等。

3、Cut the self-adhesive Velcro to suitable lengths using a pair of scissors. Remove the backing from the hairy half of the Velcro and fix it in place on the Pedal platforms using sufficient force to firmly stick it down. (Picture 15)
按照矩形梁的长度裁切699000049(TF-20) /699000055(TF-16)，粘贴于矩形梁上。（图15）

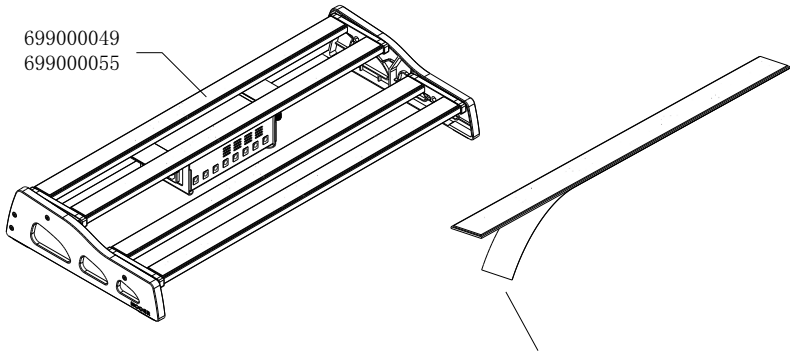

(Picture 15)

Tips: Stick the toothy half of the Velcro to the bottom of your pedals so they can be attached to your pedal board. (Picture 16)

*附送的勾面魔术贴（699000013）裁切合适的尺寸，粘贴于效果器底部，您的效果器就能与效果器板牢固结合。（图16）

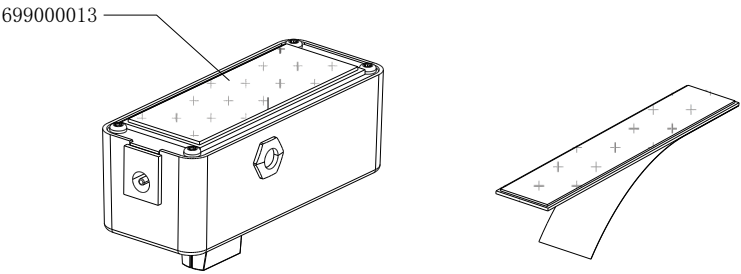

(Picture 16)

Affix the included self-adhesive cable tie retainers to the underside of your pedal platforms and use the provided cable ties to keep your cables nice and tidy. (Picture 17)

*您还可将附送的固定卡座粘贴于矩形梁底部，并用尼龙扎线带固定电源线或连接线，维持效果器板的整洁。（图17）

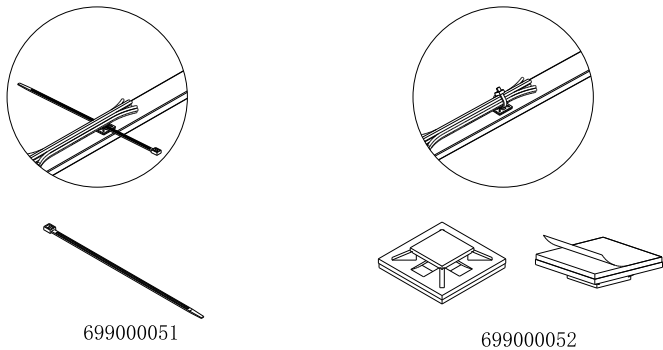

(Picture 17)

MOOER

MOOER AUDIO CO.,LTD
Shenzhen, China
www.mooeraudio.com