

*Marshall*  
AMPLIFICATION

VT-1 Vibratrem



Owners Manual

## Vibratrem Suggested Settings

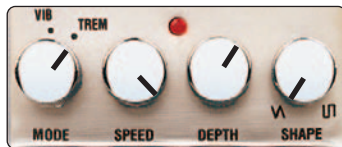

VINTAGE TREM (Amp: Clean)

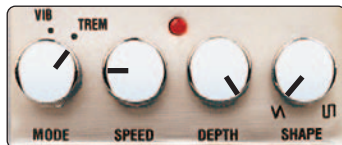

SLOW SWELL (Amp: Clean)

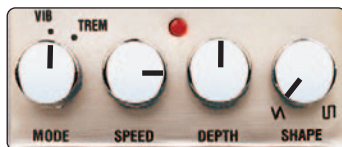

CLASSIC VIBRATO (Amp: Clean)

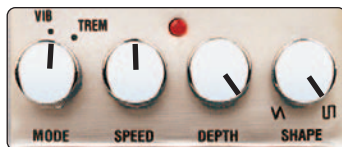

SWITCHING VIBRATO (Amp: Clean)



## From The Chairman

I would like to personally thank you for selecting one of our effects pedals.

For over 40 years the Marshall name has been synonymous with the greatest guitar tones in music. We have worked hand in hand with guitarists from all levels throughout the world to maintain and improve that special ingredient, 'The Marshall Sound.'

Our range of effects pedals gives the opportunity to augment the classic Marshall tone to add Marshall character to a guitar set-up.

All our pedals are made with the same utmost attention to quality, in both materials and manufacture as our world renowned amplifiers, cabinets and combos, in order to provide you with optimum reliability and tone.

I would like to wish you every success with all of your musical endeavours and also your new Marshall effects pedal, which I am sure you will find a pleasure to play for many years to come.

Yours Sincerely,



## WARNING!

### IMPORTANT Precautions

Refer all servicing to qualified service personnel. Servicing is required when the apparatus has been damaged in any way, such as liquid has been spilled or objects have fallen into the apparatus, the apparatus has been exposed to rain or moisture, does not operate normally, or has been dropped.

### WARNING

Do not expose the apparatus to rain or moisture. Do not expose the apparatus to dripping or splashing. No objects filled with liquids should be placed on or near the apparatus. Do not use this apparatus near water.

### Clean only with dry cloth.

Changes or modifications not expressly approved by Marshall Amplification plc could void the user's authority to operate the equipment.

Heed all warnings.  
Follow all instructions.  
Keep these instructions.

European Product Only



## Introduction

Of all the retro effects to hit the shops in recent years, perhaps the most authentic and coolest is tremolo. Instantly calling up the spirit of the 60s, Tremolo was the first effect to appear on a Marshall amp in the early 1960s. The late 90s sees Marshall updating the tremolo effect in the form of the Vibratrem.

By using split phase modulation a truly awesome stereo sound field can be created by connecting the VT-1 up to two amplifiers.

The Vibratrem features a passive bypass for the main signal path to ensure complete tonal integrity and has a quality of tone matched only by its versatility.

Here follows a complete run down of the Vibratrem's features for your information. We have also enclosed a number of suggested settings to help guide you. It should be remembered though that these are only suggested settings and you should really take the time to experiment.

If you take the time to explore the different effects within the Vibratrem, you won't be disappointed.

## Setting Up

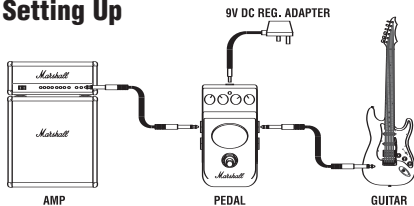

Always use good quality shielded leads.  
Always use 9V regulated DC supply with centre negative.

Although it may seem obvious the first action in achieving a good effected sound (be it duration / compression etc.) is to find the perfect bypassed sound. This will then allow the correct level to be set with the effect unit to allow a cut or boost in volume and a realistic tone.

On clean channels it is advisable to set the gain (or volume) to a setting of no less than one quarter maximum so as not to get unrealistic results due to any volume dependent tonal shaping on the amplifier preamp.

## Features

### 1. 'Out 2' Jack Socket

The Vibratrem is a stereo footpedal. If you are using the Vibratrem in a stereo configuration this Jack socket is for your second output.

### 2. 'Out 1 - Mono' Jack Socket

This is the main output of the Vibratrem and is for connection to the amplifier or to another effects pedal.

### 3. Mode

This allows you to switch between the Vibratrem's two modes, Vibrato and Tremolo.

Tremolo - refers to change in signal volume. In Tremolo mode the signal increases and decreases at a rate governed by the speed control. The tremolo on the VT-1 is specially designed to recreate the natural swell and decay of a valve-based tremolo as found on many vintage valve amplifiers.

Vibrato - By phase shifting the effected signal with respect to direct, unaffected signal, a subtle pitch shifting vibrato is created. The vibrato on the VT-1 has been developed to closely mimic the vibrato settings on certain vintage valve amplifiers. Note: the stereo output remains unchanged (i.e. tremolo) in vibrato mode.

## 4. Speed

Alters the speed of the modulation of the effect. Turn the control anti-clockwise and the effect will slow down. Conversely, turn the control clockwise and the modulation of the effect will increase in speed.

## 5. DC Input

For input of a 9 V DC adaptor should you not wish to use batteries.

## 6. LED

Indicates when the Vibratrem is in operation.

## 7. Depth

Controls the depth of the effect. Turn the control anti-clockwise and the effect will be more subtle, turn the control clockwise and the modulation of the effect will be increased.

## 8. Shape

The Shape control affects the modulation waveform of the VT-1. In short, the shape of the modulation waveform determines the manner in which the VT-1 circuitry turns the signal level up and down in creating the tremolo and shifts phase in the case of vibrato.

The triangle wave () creates a gradual swelling tremolo and subtly phasing vibrato.

The square wave () produces a more abrupt change in volume when Tremolo mode is engaged and a 'de-tuned' pitch shifting vibrato in Vibrato mode.

## 9. In Jack

This is the input jack, for connection to your guitar or to another effects pedal.

## 10. Foot Switch

For switching the Vibratrem on and off.

## Trouble Shooting

	CHECK BATTERY	CHECK LEADS	CHECK PEDAL CONTROLS	DC INLET	CHECK AMP CONTROLS	CHECK GUITAR
WHAT IF NO OUTPUT	✓	✓	✓	✓	✓	
NOISE IN BYPASS		✓				
INDICATOR LED NOT ON	✓	✓ INPUT LEAD		✓		
SOUND TOO TREBLY OR FIZZY			✓		✓	
SOUND TOO MUSHY OR BASSY		✓			✓	
UNUSUAL FEEDBACK		✓	✓ REDUCE TREBLE		✓ REDUCE TREBLE	✓
UNUSUAL HUM		✓	✓	✓	✓ MOVE AWAY FROM AMP	
BASS FEEDBACK						✓ PICKUPS MAY BE VIBRATING

## Battery Replacement

1. To replace the battery, open the easily accessed coin screw battery cover plate by loosening screw as shown, then disconnect the battery connector lead.
2. Use PP3 or equivalent battery (for improved battery life use alkaline type)
3. Always ensure that the battery is removed when the pedal is not in use for long periods.
4. Dispose of old battery in a safe place.

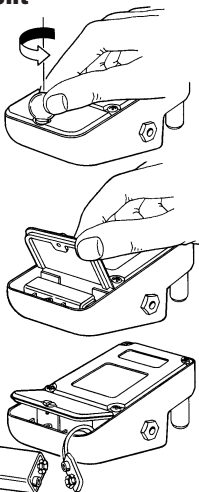

## Technical Specification

**Power:** 9V DC Centre Negative Regulated

**Current Draw:** 16mA

**Controls:** Vibrato and Tremolo Mode, Speed, Depth and Shape

**Switches:** On/Off Switch

**Indicators:** On/Off LED

**Jacks:** 1 Input, 2 Output 'Jacksockets'

**Input Impedance:** 1M $\Omega$

**Output Load Impedance:** < 1k $\Omega$

**Dimensions:** 120mm x 65mm x 55mm

**Weight:** 510 grammes